



-TOWN OF LAKEVILLE MEETING POSTING & AGENDA

Town Clerk's Time Stamp
received & posted:

48-hr notice effective
when time stamped

Notice of every meeting of a local public body must be filed and time-stamped with the Town Clerk's Office at least 48 hours prior to such meeting (excluding Saturdays, Sundays and legal holidays) and posted thereafter in accordance with the provisions of the Open Meeting Law, MGL 30A §18-22 (Ch. 28-2009). Such notice shall contain a listing of topics the Chair reasonably anticipates will be discussed at the meeting.

Name of Board or Committee:	<u>Conservation Commission</u>
Date & Time of Meeting:	<u>January 23, 2024 @ 7pm</u>
Location of Meeting:	<u>Lakeville Police Station</u> <u>323 Bedford St.</u>
Clerk/Board Member posting notice:	<u>Lori Canedy</u>

Cancelled/Postponed to: _____ (circle one)

Clerk/Board Member Cancelling/Postponing: _____

A G E N D A

1. Please ask if anyone is recording the meeting and announce that LakeCam is taping (if present).
2. 310 Kenneth Welch Drive - Notice of Intent (SE192-891) Goddard Consulting - increase parking and wetland replication. Continued from 1/9/23 meeting.
3. 9 Cross Street - Notice of Intent (SE192-902) - Zenith Consulting Engineers - new single-family dwelling, septic system, well, grading, lot clearing, utilities, driveway crossing, and replication area. Continued from 1/9/23 meeting.
4. 8 Oak Street - Notice of Intent (SE192-909) - Farland Corp. - septic upgrade. Continued from 1/9/23 meeting.
5. 9 Cottage Lane - RDA - installation of dock and boat lift.
6. 26 Central Ave - Notice of Intent (SE192-xxx) - Foresight Engineering - septic upgrade.
7. 6 Margeaux Drive - Request Certificate of Compliance SE192-323 and SE192-219.
8. Route 18/Snake River Culvert - RDA - SRPEDD - Borings/Test pits
9. Environmental education - Meet with Tabitha Yeager to discuss possible environmental education program.

Please be aware that this agenda is subject to change. If other issues requiring immediate attention of the Conservation Commission arise after the posting of this agenda, they may be addressed at this meeting.



Massachusetts Department of Environmental Protection
Bureau of Water Resources - Wetlands

WPA Form 1 - Request for Determination of Applicability

Massachusetts Wetlands Protection Act M.G.L. c. 131, §40

Municipality _____

A. General Information

RECEIVED

JAN 8 2024

Important:
When filling out forms on the computer, use only the tab key to move your cursor - do not use the return key.

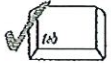

1. Applicant:

Francis	Madden
First Name	Last Name
9 Cottage Lane	Conservation Commission
Address	
Lakeville	MA
City/Town	State
6177637475	02347-2438
Phone Number	Zip Code
	madden1287@gmail.com
	Email Address

2. Property Owner (if different from Applicant):

_____	_____
First Name	Last Name
_____	_____
Address	
_____	_____
City/Town	State
_____	Zip Code
_____	_____
Phone Number	Email Address (if known)

3. Representative (if any)

_____	_____
First Name	Last Name
_____	_____
Company Name	
_____	_____
Address	
_____	_____
City/Town	State
_____	Zip Code
_____	_____
Phone Number	Email Address (if known)

B. Project Description

1. a. Project Location (use maps and plans to identify the location of the area subject to this request):

9 Cottage Lane	Lakeville
Street Address	City/Town
41.79328	-70.93313
Latitude (Decimal Degrees Format with 5 digits after decimal e.g. XX.XXXXX)	Longitude (Decimal Degrees Format with 5 digits after decimal e.g. -XX.XXXXX)
050	009
Assessors' Map Number	Assessors' Lot/Parcel Number

How to find Latitude and Longitude

and how to convert to decimal degrees

b. Area Description (use additional paper, if necessary):

85' by 203.15' by 75' by 192.75'

c. Plan and/or Map Reference(s): (use additional paper if necessary)

_____	_____
Title	Date
_____	_____
Title	Date



Massachusetts Department of Environmental Protection
Bureau of Water Resources - Wetlands

WPA Form 1- Request for Determination of Applicability

Massachusetts Wetlands Protection Act M.G.L. c. 131, §40

Municipality

B. Project Description (cont.)

2. a. Activity/Work Description (use additional paper and/or provide plan(s) of Activity, if necessary):

There will be 5 docks that are 4' by 8' straight out west degree, which is a total of 40'. Then on the right side, which faces north will be 4- 4' by 8' docks that will abut one another for a total an area of 8' by 16'. Facing the south there will be two docks that will point south, that will equal 16'. Each piece of dock has 2 feet that sit on the ground in the water. The boat lift will be on the westerly side in the middle of the platforms. The boat lift measure 9' by 10' wide and has 2 bars that extend evenly

- b. Identify provisions of the Wetlands Protection Act or regulations which may exempt the applicant from having to file a Notice of Intent for all or part of the described work (use additional paper, if necessary).

-
3. a. If this application is a Request for Determination of Scope of Alternatives for work in the Riverfront Area, indicate the one classification below that best describes the project.

- Single family house on a lot recorded on or before 8/1/96
- Single family house on a lot recorded after 8/1/96
- Expansion of an existing structure on a lot recorded after 8/1/96
- Project, other than a single-family house or public project, where the applicant owned the lot before 8/7/96
- New agriculture or aquaculture project
- Public project where funds were appropriated prior to 8/7/96
- Project on a lot shown on an approved, definitive subdivision plan where there is a recorded deed restriction limiting total alteration of the Riverfront Area for the entire subdivision
- Residential subdivision; institutional, industrial, or commercial project
- Municipal project
- District, county, state, or federal government project
- Project required to evaluate off-site alternatives in more than one municipality in an Environmental Impact Report under MEPA or in an alternatives analysis pursuant to an application for a 404 permit from the U.S. Army Corps of Engineers or 401 Water Quality Certification from the Department of Environmental Protection.

- b. Provide evidence (e.g., record of date subdivision lot was recorded) supporting the classification above (use additional paper and/or attach appropriate documents, if necessary.)



WPA Form 1- Request for Determination of Applicability

Massachusetts Wetlands Protection Act M.G.L. c. 131, §40

Municipality _____

C. Determinations

1. I request the _____ make the following determination(s). Check any that apply:
Conservation Commission

- a. whether the area depicted on plan(s) and/or map(s) referenced above is an area subject to jurisdiction of the Wetlands Protection Act.
- b. whether the boundaries of resource area(s) depicted on plan(s) and/or map(s) referenced above are accurately delineated.
- c. whether the Activities depicted on plan(s) referenced above is subject to the Wetlands Protection Act and its regulations.
- d. whether the area and/or Activities depicted on plan(s) referenced above is subject to the jurisdiction of any municipal wetlands' ordinance or bylaw of:

Name of Municipality

- e. whether the following scope of alternatives is adequate for Activities in the Riverfront Area as depicted on referenced plan(s).
- _____

D. Signatures and Submittal Requirements

I hereby certify under the penalties of perjury that the foregoing Request for Determination of Applicability and accompanying plans, documents, and supporting data are true and complete to the best of my knowledge.

I further certify that the property owner, if different from the applicant, and the appropriate DEP Regional Office were sent a complete copy of this Request (including all appropriate documentation) simultaneously with the submittal of this Request to the Conservation Commission.

Failure by the applicant to send copies in a timely manner may result in dismissal of the Request for Determination of Applicability.

Signatures:

I also understand that notification of this Request will be placed in a local newspaper at my expense in accordance with Section 10.05(3)(b)(1) of the Wetlands Protection Act regulations.

 Finnis Madden
Signature of Applicant

 December 27, 2023
Date

Signature of Representative (if any)

Date

③
65' simplified
License # 12384
2009

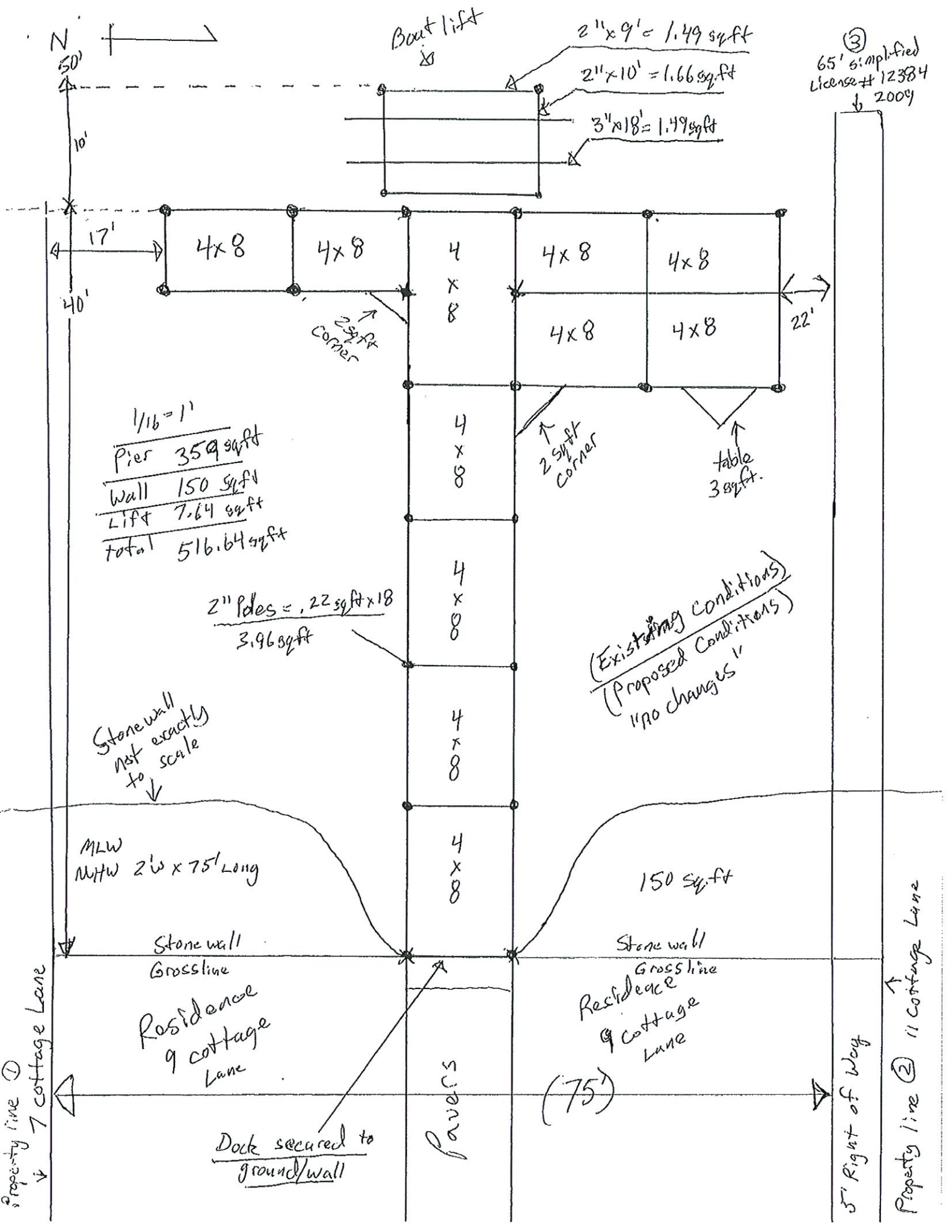

1/16 = 1'
Pier 359 sq.ft
Wall 150 sq.ft
Lift 7.64 sq.ft
Total 516.64 sq.ft

2" Poles = .22 sq.ft x 18
3.96 sq.ft

(Existing Conditions)
(Proposed Conditions)
No changes

Stone wall
not exactly
to scale

MLW
MHW 2'w x 75' Long

Stone wall
Grossline
Residence
of cottage
Lane

150 sq.ft
Stone wall
Grossline
Residence
of cottage
Lane

Dock secured to
ground/wall

Pavers

(75)

5' Right of Way

Property line ② 11 cottage Lane

Property line ①
7 cottage Lane

Q 9 Cottage Lane, Lakeville, MA

F

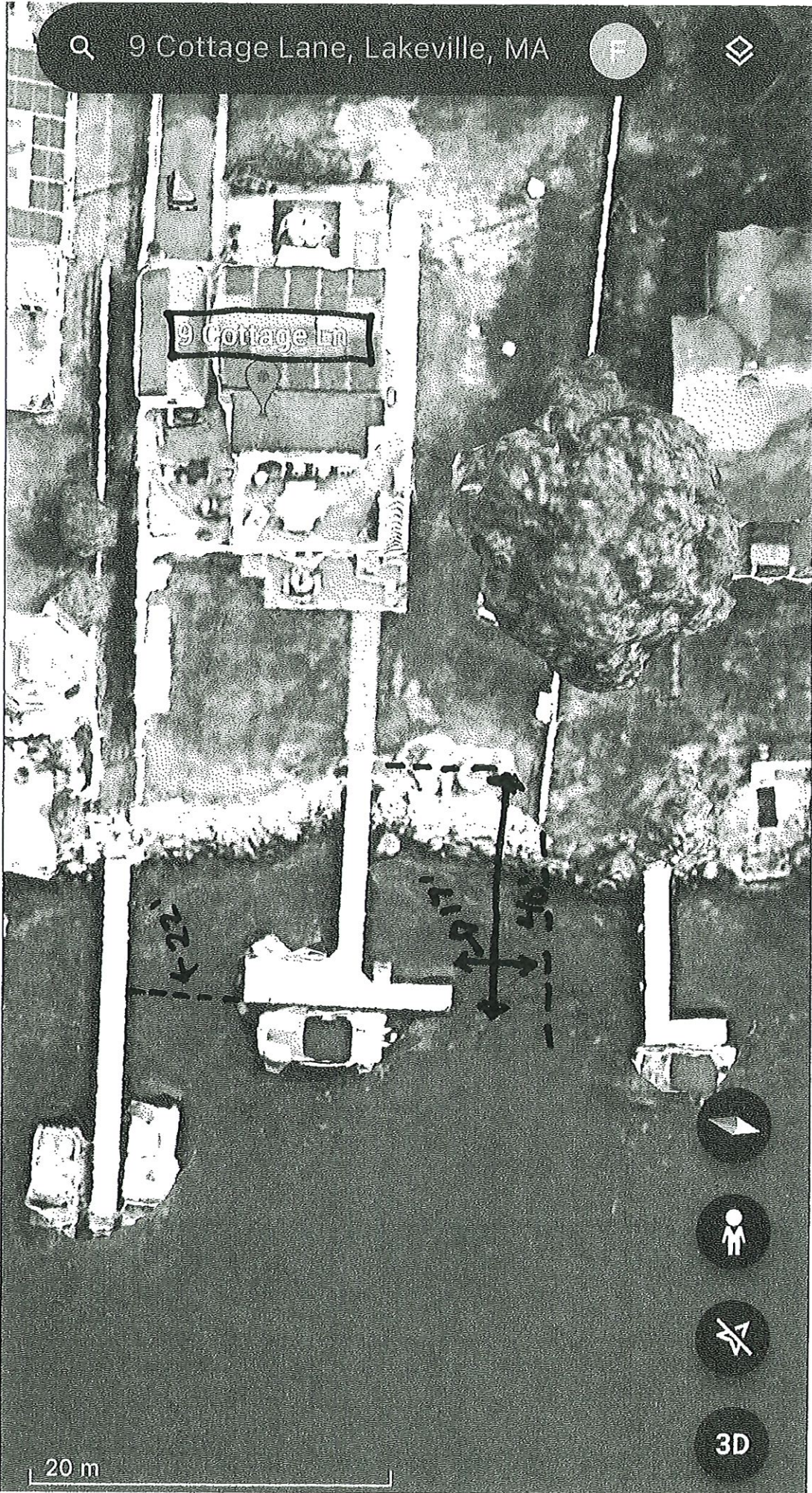

20 m

3D

Deck footing
Sits on Ground

14"

4"



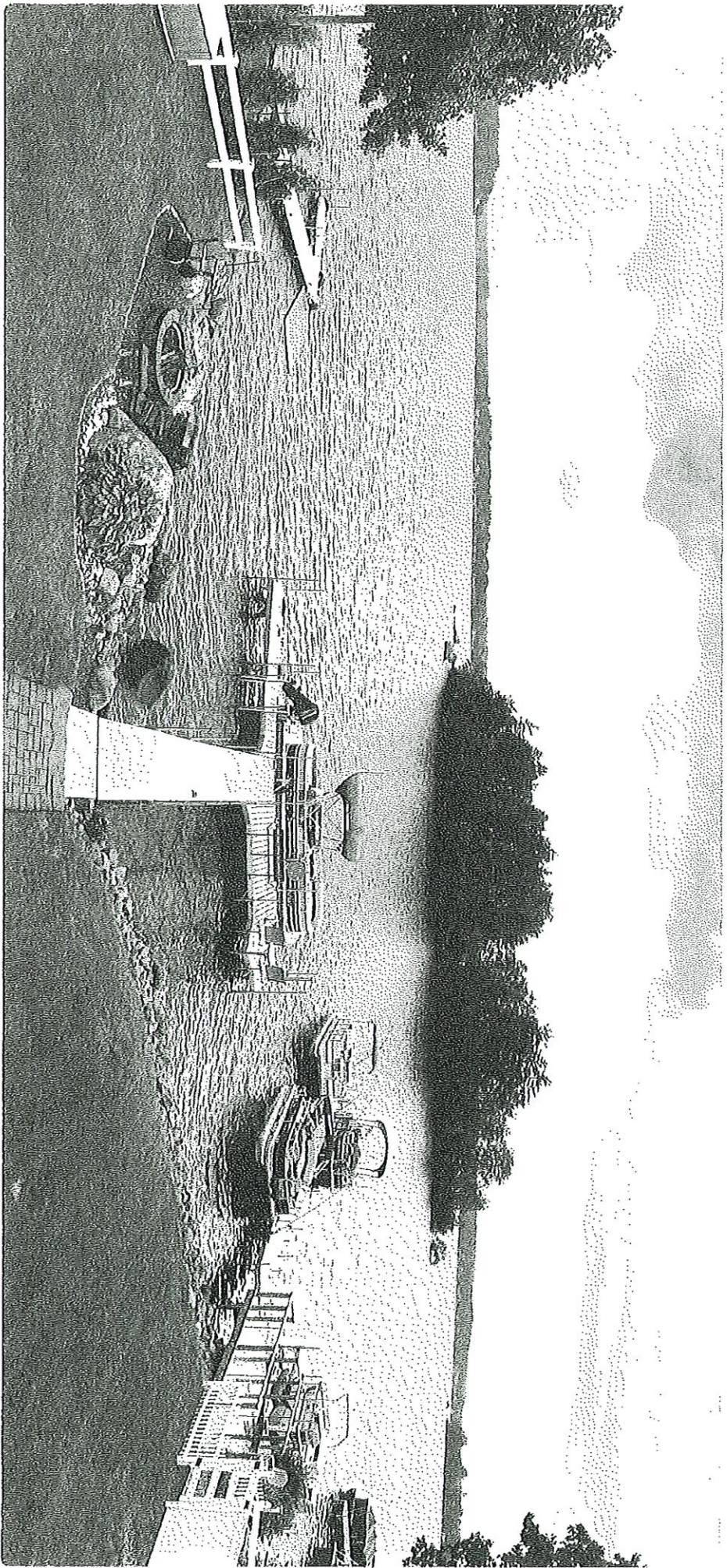



TOWN OF LAKEVILLE

Town Office Building

346 Bedford Street

Lakeville, MA 02347

CONSERVATION COMMISSION
TELEPHONE: 508-946-8823

**Town of Lakeville Conservation Commission
Notice of Public Hearing**

Pursuant to M.G.L. Ch 131, the Wetlands Protection Act, the Lakeville Conservation Commission will hold a public hearing on January 23, 2024 at 7pm at the Lakeville Police Station, 323 Bedford Street, on a Notice of intent. The applicant Francis Madden is proposing a preexisting dock to the back of his property that will extend into Long Pond for seasonal use.

The project is located at 9 Cottage Lane and is also identified as Assessor's Map 050, Block 003, Plot 009.

Foresight Engineering

518 County Road
(Wishbone Way)
West Wareham, MA 02576
508-245-2148

January 8, 2024

Lakeville Conservation Commission

RE: Notice of Intent, 26 Central Ave

Dear Commission Members:

On behalf of *James & Mary Welch Trustees*, enclosed herewith please find two (2) copies of a Notice of Intent and the accompanying plan regarding the above-referenced filing. Also enclosed you will find a checks in the amounts of \$67.50 & \$75.00 payable to the Town of *Lakeville* to cover the filing fees. Also find a check in the amount of \$75 payable to Newmarket Week to cover the legal ad fee.

The applicant is proposing to upgrade a failed septic system with retaining walls and associated grading in the front of the dwelling. The proposed septic tank and pump tanks are within the 100' buffer zone of Long Pond due to the existing plumbing. The applicant is also proposing to Erosion control measures have been shown on the plan in order to prevent the possibility of siltation migrating towards the resource areas.

Should you have any questions, require additional information, or desire to walk the site, please do not hesitate to contact me at the above listed phone number. **I have notified the abutters for the 1/23/24 meeting.** Thank you.

Sincerely,
Foresight Engineering, Inc.

Darren Michaelis
Design Engineer

Cc: DEP – Southeast



Massachusetts Department of Environmental Protection
Bureau of Resource Protection - Wetlands

Provided by MassDEP:

WPA Form 3 – Notice of Intent

Massachusetts Wetlands Protection Act M.G.L. c. 131, §40

MassDEP File Number

Document Transaction Number

Lakeville

City/Town

Important:
When filling out forms on the computer, use only the tab key to move your cursor - do not use the return key.



Note:
Before completing this form consult your local Conservation Commission regarding any municipal bylaw or ordinance.

A. General Information

1. Project Location (**Note:** electronic filers will click on button to locate project site):

26 Central Ave

a. Street Address

Lakeville

b. City/Town

02347

c. Zip Code

Latitude and Longitude:

042/024

f. Assessors Map/Plat Number

d. Latitude

003

g. Parcel /Lot Number

e. Longitude

2. Applicant:

a. First Name

James & Mary Welch Trustees

b. Last Name

c. Organization

26 Central Ave

d. Street Address

Lakeville

e. City/Town

MA

f. State

02347

g. Zip Code

h. Phone Number

i. Fax Number

j. Email Address

3. Property owner (required if different from applicant): Check if more than one owner

a. First Name

b. Last Name

c. Organization

d. Street Address

e. City/Town

f. State

g. Zip Code

h. Phone Number

i. Fax Number

j. Email address

4. Representative (if any):

Darren

a. First Name

Michaelis

b. Last Name

Foresight Engineering Inc.

c. Company

518 County Road

d. Street Address

West Wareham

e. City/Town

MA

f. State

02576

g. Zip Code

508-245-2148

h. Phone Number

i. Fax Number

foresight_enginc@yahoo.com

j. Email address

5. Total WPA Fee Paid (from NOI Wetland Fee Transmittal Form):

\$110

a. Total Fee Paid

\$67.50

b. State Fee Paid

\$42.50

c. City/Town Fee Paid



Massachusetts Department of Environmental Protection
Bureau of Resource Protection - Wetlands

Provided by MassDEP:

WPA Form 3 – Notice of Intent

Massachusetts Wetlands Protection Act M.G.L. c. 131, §40

MassDEP File Number

Document Transaction Number

Lakeville

City/Town

A. General Information (continued)

6. General Project Description:

Septic system upgrade with the proposed septic tank and pump tank within the 100' buffer of Long Pond due to existing plumbing. The system is outside of the buffer zone.

7a. Project Type Checklist: (Limited Project Types see Section A. 7b.)

- | | |
|---|---|
| 1. <input checked="" type="checkbox"/> Single Family Home | 2. <input type="checkbox"/> Residential Subdivision |
| 3. <input type="checkbox"/> Commercial/Industrial | 4. <input type="checkbox"/> Dock/Pier |
| 5. <input type="checkbox"/> Utilities | 6. <input type="checkbox"/> Coastal engineering Structure |
| 7. <input type="checkbox"/> Agriculture (e.g., cranberries, forestry) | 8. <input type="checkbox"/> Transportation |
| 9. <input type="checkbox"/> Other | |

7b. Is any portion of the proposed activity eligible to be treated as a limited project (including Ecological Restoration Limited Project) subject to 310 CMR 10.24 (coastal) or 310 CMR 10.53 (inland)?

1. Yes No If yes, describe which limited project applies to this project. (See 310 CMR 10.24 and 10.53 for a complete list and description of limited project types)

2. Limited Project Type

If the proposed activity is eligible to be treated as an Ecological Restoration Limited Project (310 CMR 10.24(8), 310 CMR 10.53(4)), complete and attach Appendix A: Ecological Restoration Limited Project Checklist and Signed Certification.

8. Property recorded at the Registry of Deeds for:

Plymouth

a. County

41749

c. Book

b. Certificate # (if registered land)

062

d. Page Number

B. Buffer Zone & Resource Area Impacts (temporary & permanent)

- Buffer Zone Only – Check if the project is located only in the Buffer Zone of a Bordering Vegetated Wetland, Inland Bank, or Coastal Resource Area.
- Inland Resource Areas (see 310 CMR 10.54-10.58; if not applicable, go to Section B.3, Coastal Resource Areas).

Check all that apply below. Attach narrative and any supporting documentation describing how the project will meet all performance standards for each of the resource areas altered, including standards requiring consideration of alternative project design or location.



Massachusetts Department of Environmental Protection
 Bureau of Resource Protection - Wetlands

Provided by MassDEP

WPA Form 3 – Notice of Intent

Massachusetts Wetlands Protection Act M.G.L. c. 131, §40

MassDEP File Number _____

Document Transaction Number _____

Lakeville

City/Town

B. Buffer Zone & Resource Area Impacts (temporary & permanent) (cont'd)

For all projects affecting other Resource Areas, please attach a narrative explaining how the resource area was delineated.

Resource Area	Size of Proposed Alteration	Proposed Replacement (if any)
a. <input type="checkbox"/> Bank	1. linear feet _____	2. linear feet _____
b. <input type="checkbox"/> Bordering Vegetated Wetland	1. square feet _____	2. square feet _____
c. <input type="checkbox"/> Land Under Waterbodies and Waterways	1. square feet _____	2. square feet _____
	3. cubic yards dredged _____	

Resource Area	Size of Proposed Alteration	Proposed Replacement (if any)
d. <input type="checkbox"/> Bordering Land Subject to Flooding	1. square feet _____	2. square feet _____
	3. cubic feet of flood storage lost _____	4. cubic feet replaced _____
e. <input type="checkbox"/> Isolated Land Subject to Flooding	1. square feet _____	
	2. cubic feet of flood storage lost _____	3. cubic feet replaced _____
f. <input type="checkbox"/> Riverfront Area	1. Name of Waterway (if available) - specify coastal or inland _____	

2. Width of Riverfront Area (check one):

- 25 ft. - Designated Densely Developed Areas only
- 100 ft. - New agricultural projects only
- 200 ft. - All other projects

3. Total area of Riverfront Area on the site of the proposed project: _____ square feet

4. Proposed alteration of the Riverfront Area:

a. total square feet _____ b. square feet within 100 ft. _____ c. square feet between 100 ft. and 200 ft. _____

5. Has an alternatives analysis been done and is it attached to this NOI? Yes No

6. Was the lot where the activity is proposed created prior to August 1, 1996? Yes No

3. Coastal Resource Areas: (See 310 CMR 10.25-10.35)

Note: for coastal riverfront areas, please complete **Section B.2.f.** above.



Massachusetts Department of Environmental Protection
 Bureau of Resource Protection - Wetlands

Provided by MassDEP:

WPA Form 3 – Notice of Intent

Massachusetts Wetlands Protection Act M.G.L. c. 131, §40

MassDEP File Number _____

Document Transaction Number _____

Lakeville

City/Town

B. Buffer Zone & Resource Area Impacts (temporary & permanent) (cont'd)

Check all that apply below. Attach narrative and supporting documentation describing how the project will meet all performance standards for each of the resource areas altered, including standards requiring consideration of alternative project design or location.

Online Users:
 Include your document transaction number (provided on your receipt page) with all supplementary information you submit to the Department.

<u>Resource Area</u>	<u>Size of Proposed Alteration</u>	<u>Proposed Replacement (if any)</u>
a. <input type="checkbox"/> Designated Port Areas	Indicate size under Land Under the Ocean, below	
b. <input type="checkbox"/> Land Under the Ocean	_____	_____
	1. square feet	

	2. cubic yards dredged	
c. <input type="checkbox"/> Barrier Beach	Indicate size under Coastal Beaches and/or Coastal Dunes below	
d. <input type="checkbox"/> Coastal Beaches	_____	_____
	1. square feet	2. cubic yards beach nourishment
e. <input type="checkbox"/> Coastal Dunes	_____	_____
	1. square feet	2. cubic yards dune nourishment
	<u>Size of Proposed Alteration</u>	<u>Proposed Replacement (if any)</u>
f. <input type="checkbox"/> Coastal Banks	_____	
	1. linear feet	
g. <input type="checkbox"/> Rocky Intertidal Shores	_____	
	1. square feet	
h. <input type="checkbox"/> Salt Marshes	_____	_____
	1. square feet	2. sq ft restoration, rehab., creation
i. <input type="checkbox"/> Land Under Salt Ponds	_____	
	1. square feet	

	2. cubic yards dredged	
j. <input type="checkbox"/> Land Containing Shellfish	_____	
	1. square feet	
k. <input type="checkbox"/> Fish Runs	Indicate size under Coastal Banks, inland Bank, Land Under the Ocean, and/or inland Land Under Waterbodies and Waterways, above	

	1. cubic yards dredged	
l. <input type="checkbox"/> Land Subject to Coastal Storm Flowage	_____	
	1. square feet	
4. <input type="checkbox"/> Restoration/Enhancement	If the project is for the purpose of restoring or enhancing a wetland resource area in addition to the square footage that has been entered in Section B.2.b or B.3.h above, please enter the additional amount here.	
	_____	_____
	a. square feet of BVW	b. square feet of Salt Marsh
5. <input type="checkbox"/> Project Involves Stream Crossings		
	_____	_____
	a. number of new stream crossings	b. number of replacement stream crossings



Massachusetts Department of Environmental Protection
Bureau of Resource Protection - Wetlands

Provided by MassDEP:

WPA Form 3 – Notice of Intent

Massachusetts Wetlands Protection Act M.G.L. c. 131, §40

MassDEP File Number _____

Document Transaction Number _____

Lakeville

City/Town

C. Other Applicable Standards and Requirements

- This is a proposal for an Ecological Restoration Limited Project. Skip Section C and complete Appendix A: Ecological Restoration Limited Project Checklists – Required Actions (310 CMR 10.11).

Streamlined Massachusetts Endangered Species Act/Wetlands Protection Act Review

1. Is any portion of the proposed project located in **Estimated Habitat of Rare Wildlife** as indicated on the most recent Estimated Habitat Map of State-Listed Rare Wetland Wildlife published by the Natural Heritage and Endangered Species Program (NHESP)? To view habitat maps, see the *Massachusetts Natural Heritage Atlas* or go to http://maps.massgis.state.ma.us/PRI_EST_HAB/viewer.htm.

- a. Yes No **If yes, include proof of mailing or hand delivery of NOI to:**

Natural Heritage and Endangered Species Program
Division of Fisheries and Wildlife
1 Rabbit Hill Road
Westborough, MA 01581

Online _____

b. Date of map _____

If yes, the project is also subject to Massachusetts Endangered Species Act (MESA) review (321 CMR 10.18). To qualify for a streamlined, 30-day, MESA/Wetlands Protection Act review, please complete Section C.1.c, and include requested materials with this Notice of Intent (NOI); *OR* complete Section C.2.f, if applicable. *If MESA supplemental information is not included with the NOI, by completing Section 1 of this form, the NHESP will require a separate MESA filing which may take up to 90 days to review (unless noted exceptions in Section 2 apply, see below).*

- c. Submit Supplemental Information for Endangered Species Review*

1. Percentage/acreage of property to be altered:

(a) within wetland Resource Area _____ percentage/acreage

(b) outside Resource Area _____ percentage/acreage

2. Assessor's Map or right-of-way plan of site

2. Project plans for entire project site, including wetland resource areas and areas outside of wetlands jurisdiction, showing existing and proposed conditions, existing and proposed tree/vegetation clearing line, and clearly demarcated limits of work **

(a) Project description (including description of impacts outside of wetland resource area & buffer zone)

(b) Photographs representative of the site

* Some projects not in Estimated Habitat may be located in Priority Habitat, and require NHESP review (see <http://www.mass.gov/eea/agencies/dfg/dfw/natural-heritage/regulatory-review/>). Priority Habitat includes habitat for state-listed plants and strictly upland species not protected by the Wetlands Protection Act.

** MESA projects may not be segmented (321 CMR 10.16). The applicant must disclose full development plans even if such plans are not required as part of the Notice of Intent process.



Massachusetts Department of Environmental Protection
Bureau of Resource Protection - Wetlands

Provided by MassDEP:

WPA Form 3 – Notice of Intent

Massachusetts Wetlands Protection Act M.G.L. c. 131, §40

MassDEP File Number _____

Document Transaction Number _____

Lakeville

City/Town

C. Other Applicable Standards and Requirements (cont'd)

- (c) MESA filing fee (fee information available at http://www.mass.gov/dfwele/dfw/nhesp/regulatory_review/mesa/esa_fee_schedule.htm).
Make check payable to "Commonwealth of Massachusetts - NHESP" and **mail to NHESP** at above address

Projects altering 10 or more acres of land, also submit:

- (d) Vegetation cover type map of site
- (e) Project plans showing Priority & Estimated Habitat boundaries
- (f) OR Check One of the Following
1. Project is exempt from MESA review.
Attach applicant letter indicating which MESA exemption applies. (See 321 CMR 10.14, http://www.mass.gov/dfwele/dfw/nhesp/regulatory_review/mesa/esa_exemptions.htm; the NOI must still be sent to NHESP if the project is within estimated habitat pursuant to 310 CMR 10.37 and 10.59.)
2. Separate MESA review ongoing. a. NHESP Tracking # _____ b. Date submitted to NHESP _____
3. Separate MESA review completed.
Include copy of NHESP "no Take" determination or valid Conservation & Management Permit with approved plan.
3. For coastal projects only, is any portion of the proposed project located below the mean high water line or in a fish run?
- a. Not applicable – project is in inland resource area only b. Yes No

If yes, include proof of mailing, hand delivery, or electronic delivery of NOI to either:

South Shore - Cohasset to Rhode Island border, and the Cape & Islands:

Division of Marine Fisheries -
Southeast Marine Fisheries Station
Attn: Environmental Reviewer
836 South Rodney French Blvd.
New Bedford, MA 02744
Email: DMF.EnvReview-South@state.ma.us

North Shore - Hull to New Hampshire border:

Division of Marine Fisheries -
North Shore Office
Attn: Environmental Reviewer
30 Emerson Avenue
Gloucester, MA 01930
Email: DMF.EnvReview-North@state.ma.us

Also if yes, the project may require a Chapter 91 license. For coastal towns in the Northeast Region, please contact MassDEP's Boston Office. For coastal towns in the Southeast Region, please contact MassDEP's Southeast Regional Office.



Massachusetts Department of Environmental Protection
Bureau of Resource Protection - Wetlands

Provided by MassDEP:

WPA Form 3 – Notice of Intent

Massachusetts Wetlands Protection Act M.G.L. c. 131, §40

MassDEP File Number

Document Transaction Number

Lakeville

City/Town

C. Other Applicable Standards and Requirements (cont'd)

Online Users:
Include your document transaction number (provided on your receipt page) with all supplementary information you submit to the Department.

4. Is any portion of the proposed project within an Area of Critical Environmental Concern (ACEC)?
- a. Yes No If yes, provide name of ACEC (see instructions to WPA Form 3 or MassDEP Website for ACEC locations). **Note:** electronic filers click on Website.
- b. ACEC
5. Is any portion of the proposed project within an area designated as an Outstanding Resource Water (ORW) as designated in the Massachusetts Surface Water Quality Standards, 314 CMR 4.00?
- a. Yes No
6. Is any portion of the site subject to a Wetlands Restriction Order under the Inland Wetlands Restriction Act (M.G.L. c. 131, § 40A) or the Coastal Wetlands Restriction Act (M.G.L. c. 130, § 105)?
- a. Yes No
7. Is this project subject to provisions of the MassDEP Stormwater Management Standards?
- a. Yes. Attach a copy of the Stormwater Report as required by the Stormwater Management Standards per 310 CMR 10.05(6)(k)-(q) and check if:
1. Applying for Low Impact Development (LID) site design credits (as described in Stormwater Management Handbook Vol. 2, Chapter 3)
 2. A portion of the site constitutes redevelopment
 3. Proprietary BMPs are included in the Stormwater Management System.
- b. No. Check why the project is exempt:
1. Single-family house
 2. Emergency road repair
 3. Small Residential Subdivision (less than or equal to 4 single-family houses or less than or equal to 4 units in multi-family housing project) with no discharge to Critical Areas.

D. Additional Information

- This is a proposal for an Ecological Restoration Limited Project. Skip Section D and complete Appendix A: Ecological Restoration Notice of Intent – Minimum Required Documents (310 CMR 10.12).

Applicants must include the following with this Notice of Intent (NOI). See instructions for details.

Online Users: Attach the document transaction number (provided on your receipt page) for any of the following information you submit to the Department.

1. USGS or other map of the area (along with a narrative description, if necessary) containing sufficient information for the Conservation Commission and the Department to locate the site. (Electronic filers may omit this item.)
2. Plans identifying the location of proposed activities (including activities proposed to serve as a Bordering Vegetated Wetland [BVW] replication area or other mitigating measure) relative to the boundaries of each affected resource area.



Massachusetts Department of Environmental Protection
Bureau of Resource Protection - Wetlands

Provided by MassDEP:

WPA Form 3 – Notice of Intent

Massachusetts Wetlands Protection Act M.G.L. c. 131, §40

MassDEP File Number

Document Transaction Number

Lakeville

City/Town

D. Additional Information (cont'd)

3. Identify the method for BVW and other resource area boundary delineations (MassDEP BVW Field Data Form(s), Determination of Applicability, Order of Resource Area Delineation, etc.), and attach documentation of the methodology.

4. List the titles and dates for all plans and other materials submitted with this NOI.

Septic System Upgrade- Microfast 0.5

a. Plan Title

Foresight Engineering Inc.

Kevin Walker

b. Prepared By

c. Signed and Stamped by

1/1/24

1"=10'

d. Final Revision Date

e. Scale

f. Additional Plan or Document Title

g. Date

5. If there is more than one property owner, please attach a list of these property owners not listed on this form.
6. Attach proof of mailing for Natural Heritage and Endangered Species Program, if needed.
7. Attach proof of mailing for Massachusetts Division of Marine Fisheries, if needed.
8. Attach NOI Wetland Fee Transmittal Form
9. Attach Stormwater Report, if needed.

E. Fees

1. Fee Exempt: No filing fee shall be assessed for projects of any city, town, county, or district of the Commonwealth, federally recognized Indian tribe housing authority, municipal housing authority, or the Massachusetts Bay Transportation Authority.

Applicants must submit the following information (in addition to pages 1 and 2 of the NOI Wetland Fee Transmittal Form) to confirm fee payment:

2357

2. Municipal Check Number

1/8/24

3. Check date

2359

4. State Check Number

1/8/24

5. Check date

Foresight Engineering Inc.

6. Payor name on check: First Name

7. Payor name on check: Last Name



Massachusetts Department of Environmental Protection
Bureau of Resource Protection - Wetlands

Provided by MassDEP:

WPA Form 3 – Notice of Intent

Massachusetts Wetlands Protection Act M.G.L. c. 131, §40

MassDEP File Number

Document Transaction Number

Lakeville

City/Town

F. Signatures and Submittal Requirements

I hereby certify under the penalties of perjury that the foregoing Notice of Intent and accompanying plans, documents, and supporting data are true and complete to the best of my knowledge. I understand that the Conservation Commission will place notification of this Notice in a local newspaper at the expense of the applicant in accordance with the wetlands regulations, 310 CMR 10.05(5)(a).

I further certify under penalties of perjury that all abutters were notified of this application, pursuant to the requirements of M.G.L. c. 131, § 40. Notice must be made by Certificate of Mailing or in writing by hand delivery or certified mail (return receipt requested) to all abutters within 100 feet of the property line of the project location.

1. Signature of Applicant

2. Date

3. Signature of Property Owner (if different)

4. Date

1/8/24

5. Signature of Representative (if any)

6. Date

For Conservation Commission:

Two copies of the completed Notice of Intent (Form 3), including supporting plans and documents, two copies of the NOI Wetland Fee Transmittal Form, and the city/town fee payment, to the Conservation Commission by certified mail or hand delivery.

For MassDEP:

One copy of the completed Notice of Intent (Form 3), including supporting plans and documents, one copy of the NOI Wetland Fee Transmittal Form, and a **copy** of the state fee payment to the MassDEP Regional Office (see Instructions) by certified mail or hand delivery.

Other:

If the applicant has checked the "yes" box in any part of Section C, Item 3, above, refer to that section and the Instructions for additional submittal requirements.

The original and copies must be sent simultaneously. Failure by the applicant to send copies in a timely manner may result in dismissal of the Notice of Intent.



Massachusetts Department of Environmental Protection
 Bureau of Resource Protection - Wetlands
NOI Wetland Fee Transmittal Form
 Massachusetts Wetlands Protection Act M.G.L. c. 131, §40

Important: When filling out forms on the computer, use only the tab key to move your cursor - do not use the return key.



A. Applicant Information

1. Location of Project:

26 Central Ave
 a. Street Address Lakeville
 2359
 b. City/Town
 c. Check number \$42.50
 d. Fee amount

2. Applicant Mailing Address:

a. First Name James & Mary Welch Trustees
 b. Last Name
 c. Organization
 26 Central Ave
 d. Mailing Address
 Lakeville MA 02347
 e. City/Town f. State g. Zip Code
 h. Phone Number i. Fax Number j. Email Address

3. Property Owner (if different):

a. First Name
 b. Last Name
 c. Organization
 d. Mailing Address
 e. City/Town f. State g. Zip Code
 h. Phone Number i. Fax Number j. Email Address

B. Fees

To calculate filing fees, refer to the category fee list and examples in the instructions for filling out WPA Form 3 (Notice of Intent).

Fee should be calculated using the following process & worksheet. **Please see Instructions before filling out worksheet.**

Step 1/Type of Activity: Describe each type of activity that will occur in wetland resource area and buffer zone.

Step 2/Number of Activities: Identify the number of each type of activity.

Step 3/Individual Activity Fee: Identify each activity fee from the six project categories listed in the instructions.

Step 4/Subtotal Activity Fee: Multiply the number of activities (identified in Step 2) times the fee per category (identified in Step 3) to reach a subtotal fee amount. Note: If any of these activities are in a Riverfront Area in addition to another Resource Area or the Buffer Zone, the fee per activity should be multiplied by 1.5 and then added to the subtotal amount.

Step 5/Total Project Fee: Determine the total project fee by adding the subtotal amounts from Step 4.

Step 6/Fee Payments: To calculate the state share of the fee, divide the total fee in half and subtract \$12.50. To calculate the city/town share of the fee, divide the total fee in half and add \$12.50.



Massachusetts Department of Environmental Protection
 Bureau of Resource Protection - Wetlands
NOI Wetland Fee Transmittal Form
 Massachusetts Wetlands Protection Act M.G.L. c. 131, §40

B. Fees (continued)

Step 1/Type of Activity	Step 2/Number of Activities	Step 3/Individual Activity Fee	Step 4/Subtotal Activity Fee
Septic Upgrade	1	\$110.00	\$110.00
_____	_____	_____	_____
_____	_____	_____	_____
_____	_____	_____	_____
_____	_____	_____	_____
_____	_____	_____	_____
_____	_____	_____	_____
_____	_____	_____	_____
Step 5/Total Project Fee:			\$110.00
Step 6/Fee Payments:			
Total Project Fee:			\$110.00
State share of filing Fee:			\$42.50
City/Town share of filing Fee:			\$67.50
			a. Total Fee from Step 5
			b. 1/2 Total Fee less \$12.50
			c. 1/2 Total Fee plus \$12.50

C. Submittal Requirements

a.) Complete pages 1 and 2 and send with a check or money order for the state share of the fee, payable to the Commonwealth of Massachusetts.

Department of Environmental Protection
 Box 4062
 Boston, MA 02211

b.) **To the Conservation Commission:** Send the Notice of Intent or Abbreviated Notice of Intent; a copy of this form; and the city/town fee payment.

To MassDEP Regional Office (see Instructions): Send a copy of the Notice of Intent or Abbreviated Notice of Intent; a copy of this form; and a copy of the state fee payment. (E-filers of Notices of Intent may submit these electronically.)

Town of Lakeville Conservation Commission
Notice of Public Hearing

Pursuant to M.G.L. Ch 131, the Wetlands Protection Act, the Lakeville Conservation Commission will hold a public hearing on January 23rd, 2024 at 7pm at the Lakeville Police Station, 323 Bedford Street, on a Notice of Intent filing. The applicant, James & Mary Welch Trustees, are proposing to upgrade the failed septic system with the proposed septic tank and pump tank within 100' of Long Pond due to existing plumbing location.

The project is located at 26 Central Ave and also identified as Assessors
Map 042 Block 024 Lot 003

**Notification to Abutters Under the
Massachusetts Wetlands Protection Act**

In accordance with the second paragraph of Massachusetts General Laws Chapter 131, Section 40, you are hereby notified of the following.

- A. The name of the applicant is James & Mary Welch Trustees
- B. Property is owned by: James & Mary Welch Trustees
- C. The applicant has filed a Notice of Intent with the Conservation Commission for the municipality of Lakeville, Massachusetts seeking permission to remove, fill, dredge or alter an Area Subject to Protection Under the Wetlands Protection Act (General Laws Chapter 131, Section 40).
- D. The address of the lot where the activity is proposed is 26 Central Ave
- E. Assessors Map and Lot Number: 042/024/003
- F. Copies of the Notice of Intent may be examined at Lakeville Conservation Commission between the hours of 9:00 a.m. and 4:30 p.m. Monday through Friday.
- G. Brief description of project: Septic system upgrade with proposed septic tank and pump tank within the 100' of Long Pond due to location of existing plumbing.
- H. Copies of the Notice of Intent may be obtained from either (check one) the Applicant _____ or the applicant's representative X, by calling this telephone number 508-245-2148 between the hours of 9 and 3 on the following days of the week: Mon-Thurs
- I. Information regarding the date, time, and place of the public hearing may be obtained from the Lakeville Conservation Commission by calling 508-946-8823 between 9:00 a.m. and 4:30 p.m. Monday through Friday.

NOTE: Notice of the public hearing, including its date, time, and place, will be Published at least five (5) days in advance in the Newmarket Week.

NOTE: You may contact the Department of Environmental Protection Regional office at 508-946-2800 for more information.

**LAKEVILLE CONSERVATION MEETING
1/23/24 @ 7PM IN THE LAKEVILLE POLICE STATION
323 BEDFORD ST, LAKEVILLE**

AFFIDAVIT OF SERVICE

Under
Massachusetts Wetlands Protection Act M.G.L. c.131, §40

I, Darren Michaelis, hereby certify under the pains and penalties of perjury that on *1/8/24*, I will give notification to abutters in compliance with Massachusetts Wetlands Protection Act M.G.L. c.131, §40 in connection with the following matter:

A Notice of Intent (NOI) has been filed under Massachusetts Wetlands Protection Act M.G.L. c.131, §40, by the applicant, *James & Mary Welch Trustees*, with the Town of *Lakeville* Conservation Commission, for the purpose of *a septic system upgrade with proposed septic tank and pump tank within the 100' buffer zone of Long Pond due to existing plumbing location.*

The notification letter, a list of the abutters to whom it was given to and their addresses, are enclosed with this Affidavit of Service.

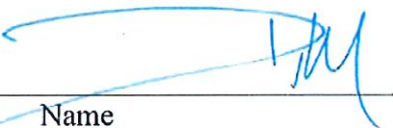

Name



Date

City of Taunton Water Department
91 Precinct Street
Lakeville, MA 02347
FS23-097NOI

City of Taunton Water Department
91 Precinct Street
Lakeville, MA 02347
FS23-097NOI

City of Taunton Water Department
91 Precinct Street
Lakeville, MA 02347
FS23-097NOI

City of New Bedford Water Div
1 Negus Way
E. Freetown, MA 02717
FS23-097NOI

City of New Bedford Water Div
1 Negus Way
E. Freetown, MA 02717
FS23-097NOI

City of New Bedford Water Div
1 Negus Way
E. Freetown, MA 02717
FS23-097NOI

Charles Loranger
24 Central Ave
Lakeville, MA 02347
FS23-097NOI

Charles Loranger
24 Central Ave
Lakeville, MA 02347
FS23-097NOI

Charles Loranger
24 Central Ave
Lakeville, MA 02347
FS23-097NOI

Nicholas Cloutier
25 Central Ave
Lakeville, MA 02347
FS23-097NOI

Nicholas Cloutier
25 Central Ave
Lakeville, MA 02347
FS23-097NOI

Nicholas Cloutier
25 Central Ave
Lakeville, MA 02347
FS23-097NOI

Sharon Gonsalves
PO Box 174
E. Freetown, MA 02717
FS23-097NOI

Sharon Gonsalves
PO Box 174
E. Freetown, MA 02717
FS23-097NOI

Sharon Gonsalves
PO Box 174
E. Freetown, MA 02717
FS23-097NOI

Robert & Carole Sullivan
119 Brewster Ave
Braintree, MA 02184
FS23-097NOI

Robert & Carole Sullivan
119 Brewster Ave
Braintree, MA 02184
FS23-097NOI

Robert & Carole Sullivan
119 Brewster Ave
Braintree, MA 02184
FS23-097NOI

Ronald & Donna Caramanica
21 Central Ave
Lakeville, MA 02347
FS23-097NOI

Ronald & Donna Caramanica
21 Central Ave
Lakeville, MA 02347
FS23-097NOI

Ronald & Donna Caramanica
21 Central Ave
Lakeville, MA 02347
FS23-097NOI

Edward & Loretta Martin
2 Jewel St
Mansfield, MA 02048
FS23-097NOI

Edward & Loretta Martin
2 Jewel St
Mansfield, MA 02048
FS23-097NOI

Edward & Loretta Martin
2 Jewel St
Mansfield, MA 02048
FS23-097NOI

Allen Lentini
39 Bluepoint Rd
Fairhaven, MA 02719
FS23-097NOI

Allen Lentini
39 Bluepoint Rd
Fairhaven, MA 02719
FS23-097NOI

Allen Lentini
39 Bluepoint Rd
Fairhaven, MA 02719
FS23-097NOI

David & Marianne Pope
43 Day Street
North Easton, MA 02356
FS23-097NOI

David & Marianne Pope
43 Day Street
North Easton, MA 02356
FS23-097NOI

David & Marianne Pope
43 Day Street
North Easton, MA 02356
FS23-097NOI

NHESP Priority Habitats of Rare Specie

NHESP Estimated Habitats of Rare
Wildlife

Property Tax Parcels



MassMapper

Leaflet | Mapbox

Zone A



Property Tax Parcels



MassMapper

Local | MassGIS

USGS Topographic Maps

Zone A



Property Tax Parcels

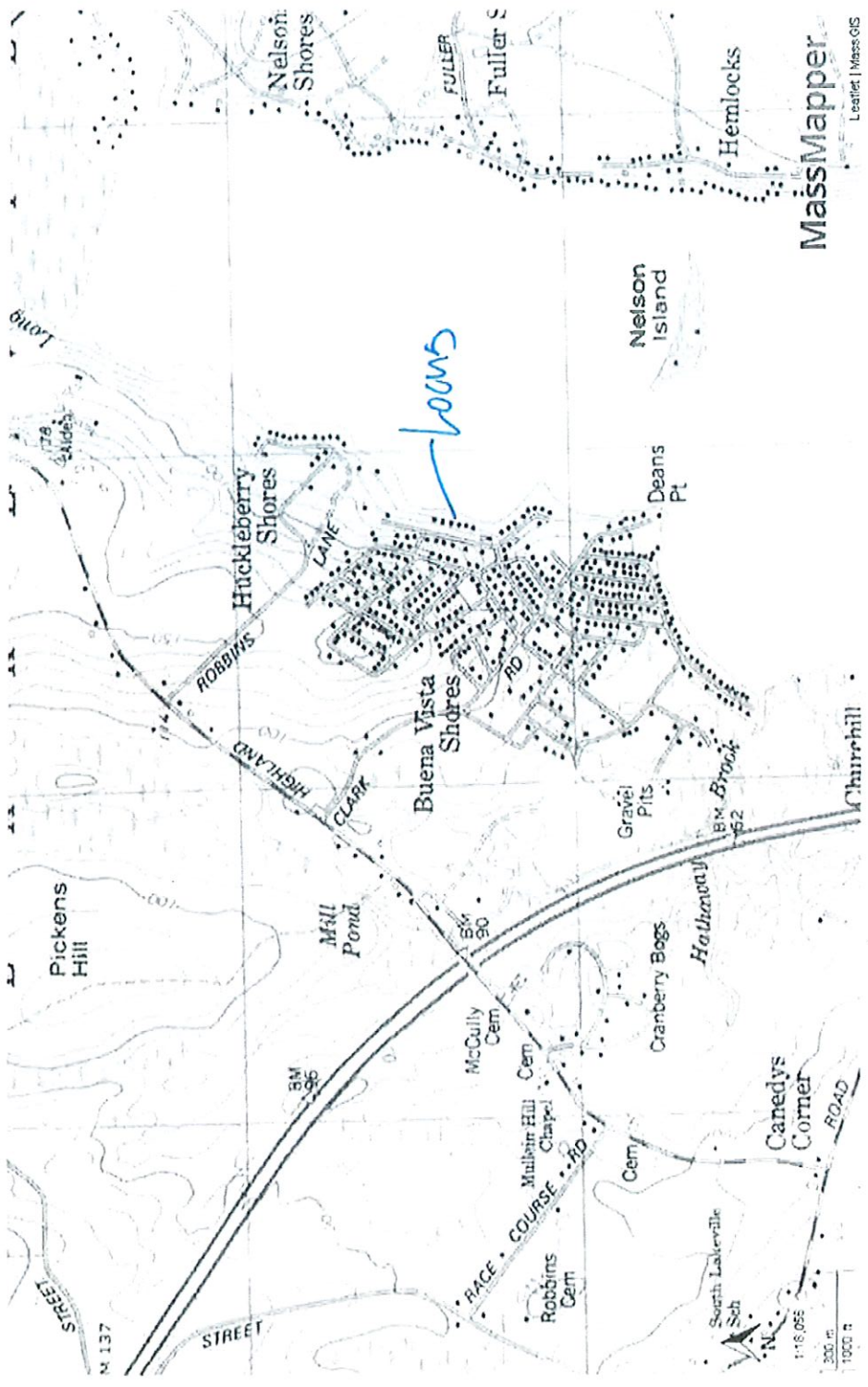

GENERAL NOTES

- 1) THE SEWAGE DISPOSAL SYSTEM SHALL BE CONSTRUCTED IN CONFORMANCE WITH THE REGULATIONS OF TITLE 3 OF THE STATE OF MASSACHUSETTS, CHAPTER 245A, SEWERAGE AND SANITATION, AND THE REGULATIONS OF THE LOCAL BOARD OF HEALTH AND THE REGULATIONS OF THE LOCAL BOARD OF HEALTH.
- 2) THE LOCAL BOARD OF HEALTH AND THIS FIRM ARE TO BE NOTIFIED OF ANY CHANGES TO THE DESIGN OR CONSTRUCTION OF THE SEWAGE DISPOSAL SYSTEM PRIOR TO THE COMMENCEMENT OF CONSTRUCTION. THE FIRM SHALL BE RESPONSIBLE FOR OBTAINING THE NECESSARY PERMITS AND APPROVALS FROM THE LOCAL BOARD OF HEALTH AND THE LOCAL BOARD OF HEALTH.
- 3) CONTRACTOR TO VERIFY ALL UTILITY LOCATIONS PRIOR TO CONSTRUCTION. CONTRACTOR SHALL BE RESPONSIBLE FOR OBTAINING ALL NECESSARY PERMITS AND APPROVALS FROM THE LOCAL BOARD OF HEALTH AND THE LOCAL BOARD OF HEALTH.
- 4) ALL SEWAGE SYSTEM COMPONENTS SHALL WITHSTAND H-10 OR H-20 AS APPLICABLE TO THE DESIGN FACILITY. CONTRACTOR SHALL BE RESPONSIBLE FOR OBTAINING ALL NECESSARY PERMITS AND APPROVALS FROM THE LOCAL BOARD OF HEALTH AND THE LOCAL BOARD OF HEALTH.
- 5) WHERE REQUIRED CONTRACTOR WILL REMOVE ALL LOAM, SUBSOIL AND EXISTING MATERIAL FROM THE DESIGN FACILITY. CONTRACTOR SHALL REPLACE ALL REMOVED MATERIAL WITH CLEAN GRADE SAND FREE FROM ORGANIC MATTER AND OTHER CONTAMINANTS. CONTRACTOR SHALL HAVE AN INSPECTOR PRESENT AT ALL TIMES DURING CONSTRUCTION TO VERIFY THE QUALITY OF THE MATERIAL TO BE USED IN THE DESIGN FACILITY. CONTRACTOR SHALL BE RESPONSIBLE FOR OBTAINING ALL NECESSARY PERMITS AND APPROVALS FROM THE LOCAL BOARD OF HEALTH AND THE LOCAL BOARD OF HEALTH.
- 6) CONTRACTOR SHALL BE RESPONSIBLE FOR OBTAINING ALL NECESSARY PERMITS AND APPROVALS FROM THE LOCAL BOARD OF HEALTH AND THE LOCAL BOARD OF HEALTH.
- 7) THIS SYSTEM IS NOT DESIGNED FOR USE WITH A GARAGE DISPOSAL UNIT. CONTRACTOR SHALL BE RESPONSIBLE FOR OBTAINING ALL NECESSARY PERMITS AND APPROVALS FROM THE LOCAL BOARD OF HEALTH AND THE LOCAL BOARD OF HEALTH.
- 8) CONTRACTOR IS TO VERIFY EXISTING MARKS, EXISTING UTILITIES, AND TOPOGRAPHY PRIOR TO CONSTRUCTION. CONTRACTOR SHALL BE RESPONSIBLE FOR OBTAINING ALL NECESSARY PERMITS AND APPROVALS FROM THE LOCAL BOARD OF HEALTH AND THE LOCAL BOARD OF HEALTH.
- 9) CONTRACTOR SHALL BE RESPONSIBLE FOR OBTAINING ALL NECESSARY PERMITS AND APPROVALS FROM THE LOCAL BOARD OF HEALTH AND THE LOCAL BOARD OF HEALTH.
- 10) ALL COVERS TO CHASE ARE TO BE WATERPROOF AND SECURABLE.
- 11) CONTRACTOR SHALL BE RESPONSIBLE FOR OBTAINING ALL NECESSARY PERMITS AND APPROVALS FROM THE LOCAL BOARD OF HEALTH AND THE LOCAL BOARD OF HEALTH.
- 12) THE CONTRACTOR IS TO DECOMMISSION THE EXISTING SEPTIC SYSTEM IN ACCORDANCE WITH STATE T-303A.

WELL NOTES

THERE ARE NO SURFACE WATER SUPPLIES OR GRAVEL PACKED PUBLIC WATER SUPPLIES WITHIN 400 FT OF PROPOSED SYSTEM. THE PROPOSED SYSTEM SHALL BE DESIGNED TO WITHSTAND 150 FT OF PROPOSED SYSTEM OTHER THAN ONCE SHOWN ON PLAN.

DESIGN AND INSTALLATION REQUIREMENTS:

- 1) ALLOWABLE REDUCTION OF 54G UP TO 50G AND/OR
 - 2) SYSTEM OWNER REQUIREMENTS: 1-6
 - 3) DECISION NOTICE TO BE RECORDED
 - 4) O&M CONTRACT REQUIRED
- MAINTAIN ALL INSPECTION RECORDS SUBMITTED BY 3/1

DESIGN CAPACITY REQUIRED

3 BEDROOMS AT 110 GALS/DAY/PERSON = 330 GALS/DAY
 2 SEPTIC TANK VOLUME
 300 GALS X 200E = 600 GALS DESIGN CAPACITY
 MINIMUM OF 1500 GALLON TANK REQUIRED

SYSTEM CAPACITY PROVIDED

CAPACITY REQUIRED= 330 GPD / 0.8550075 = 1000 SF. (60% REDUCTION PER TREATMENT)
 BOTTOM AREA: 16' W X 3.56' L = 652 SF. X 0.33 = 174 GALS/DAY X 2 = 348 GPD

PROPERTY INFORMATION

DEED BOOK/PAGE: 41740/062 PLAN BOOK/PAGE: 08 /174
 ASSESSORS MAP/LOT: 042/024/003 PLAN DATE: 3/18/20
 PLAN TITLE: INDIAN ROCK SHORES- LOT #20

SEWAGE DISPOSAL SYSTEM UPGRADE DESIGN

PREPARED FOR: JAMES & MARY WELCH TRUSTEES
 26 CENTRAL AVE
 LAKEVILLE, MA 02447

LOCATED AT: 26 CENTRAL AVE
 LAKEVILLE, MASSACHUSETTS

DATE: 11/1/24 TIME: 10:00 AM
 DRAWN BY: J. WELCH
 CHECKED BY: J. WELCH
 PROJECT: 042-024-003

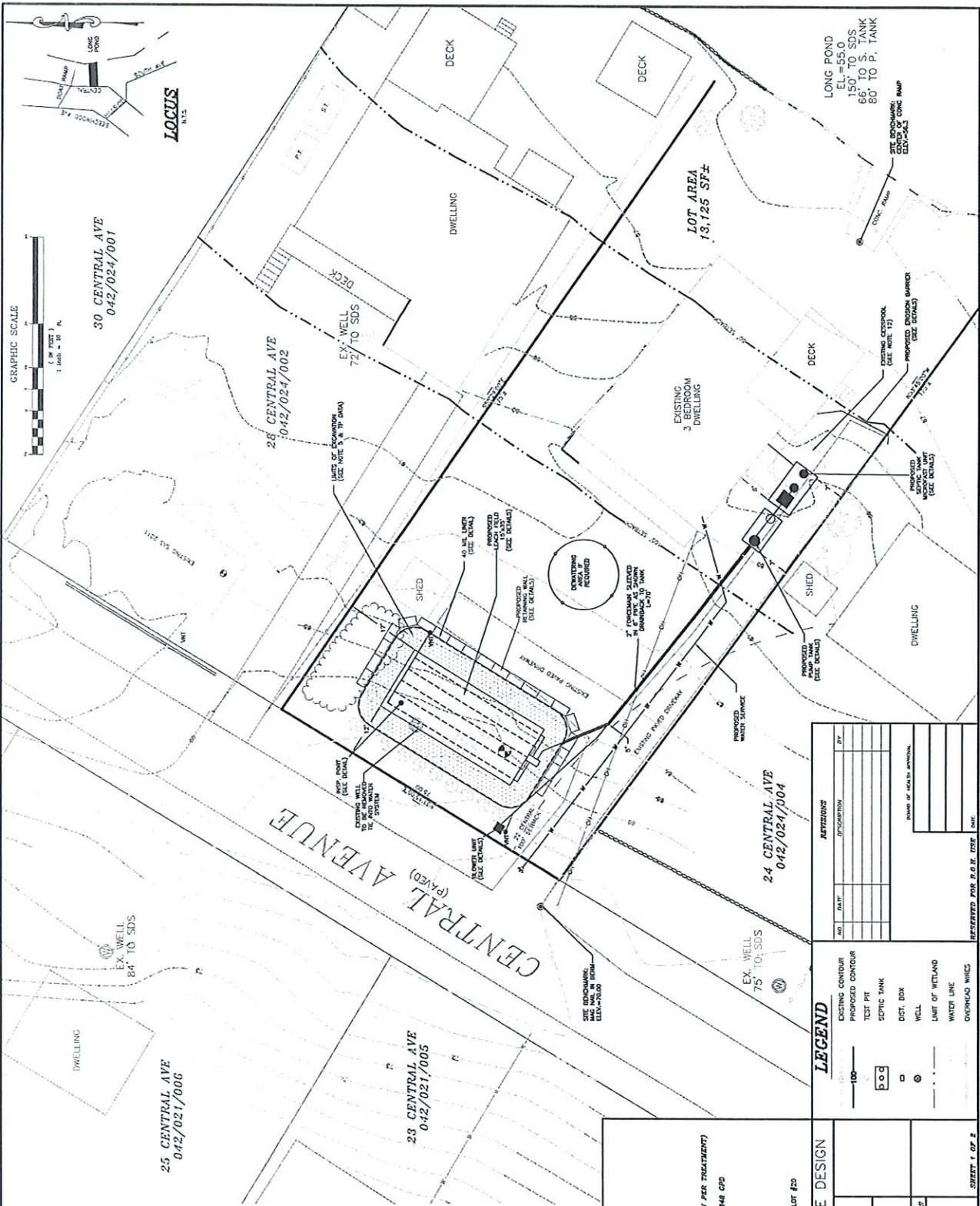
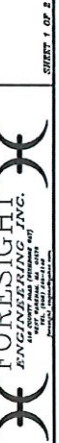

GRAPHIC SCALE
 1 inch = 10 ft.

30 CENTRAL AVE
 042/024/001

28 CENTRAL AVE
 042/024/002

25 CENTRAL AVE
 042/021/006

23 CENTRAL AVE
 042/021/005

24 CENTRAL AVE
 042/024/004

LOT AREA
 13,155 SF±

EXISTING 3 BEDROOM DWELLING

EXISTING 3 BEDROOM DWELLING

EXISTING 3 BEDROOM DWELLING

EXISTING 3 BEDROOM DWELLING

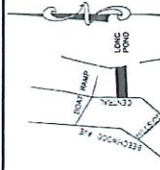

LOCUST AVE

CENTRAL AVE

LONG POND

LONG POND
 EL.=55.0
 150' TO SDS
 80' TO P. TANK
 80' TO P. TANK

EXISTING 3 BEDROOM DWELLING

EXISTING 3 BEDROOM DWELLING

EXISTING 3 BEDROOM DWELLING

EXISTING 3 BEDROOM DWELLING

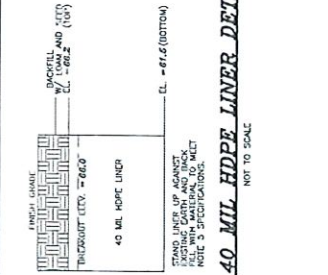

40 MIL HDPE LINER DETAIL
NOT TO SCALE

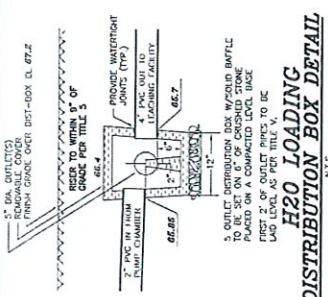

H2O LOADING DISTRIBUTION BOX DETAIL
NOT TO SCALE

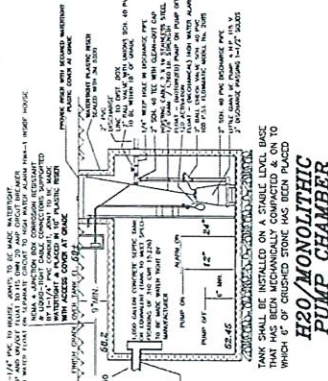

H2O/MONOLITHIC PUMP CHAMBER
NOT TO SCALE

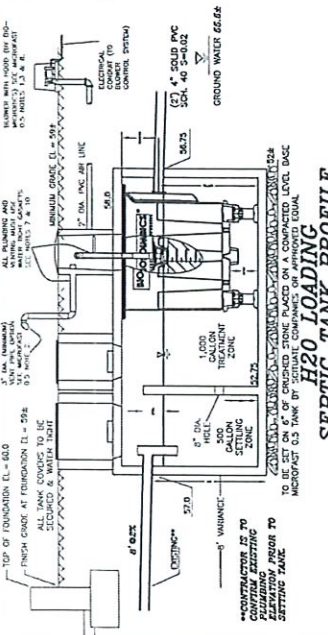

H2O LOADING SEPTIC TANK PROFILE
NOT TO SCALE



SILT SOCK BARRIER
NOT TO SCALE

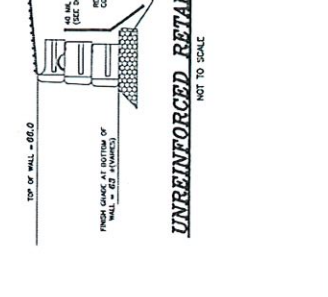

UNREINFORCED RETAINING WALL
NOT TO SCALE

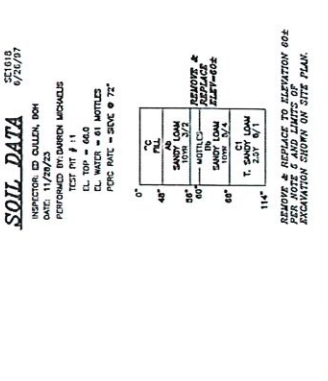

SOIL DATA
NOT TO SCALE

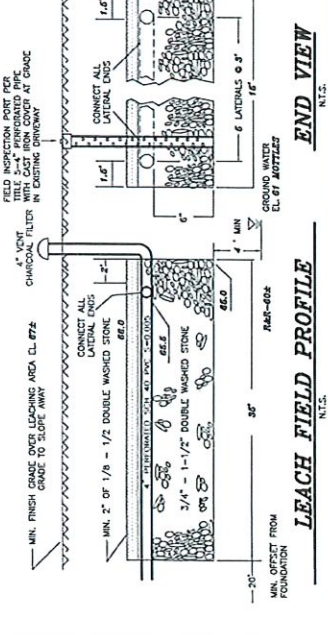

LEACH FIELD PROFILE
NOT TO SCALE

LOCAL UPGRADE REQUESTS:

1. A REDUCTION OF THE SETBACK OF THE PROPOSED SEPTIC TANK TO THE PROPOSED LANE FROM 10' TO 3' MINIMUM PER SECTION 15.405(1)(b), SHOWN AS 7' ON PLAN.
2. A REDUCTION OF THE SETBACK OF THE PROPOSED PUMP TANK TO THE PROPOSED LANE FROM 10' TO 3' MINIMUM PER SECTION 15.405(1)(b), SHOWN AS 7' ON PLAN.
3. A REDUCTION OF THE SETBACK OF THE PROPOSED SEPTIC TANK TO THE PROPOSED LANE FROM 10' TO 3' MINIMUM PER SECTION 15.405(1)(b), SHOWN AS 7' ON PLAN.
4. A REDUCTION OF THE SETBACK OF THE PROPOSED SEPTIC TANK TO THE PROPOSED LANE FROM 10' TO 3' MINIMUM PER SECTION 15.405(1)(b), SHOWN AS 7' ON PLAN.
5. A REDUCTION OF THE SETBACK OF THE PROPOSED SEPTIC TANK TO THE PROPOSED LANE FROM 10' TO 3' MINIMUM PER SECTION 15.405(1)(b), SHOWN AS 7' ON PLAN.
6. A REDUCTION OF THE SETBACK OF THE PROPOSED SEPTIC TANK TO THE PROPOSED LANE FROM 10' TO 3' MINIMUM PER SECTION 15.405(1)(b), SHOWN AS 7' ON PLAN.
7. A REDUCTION OF THE SETBACK OF THE PROPOSED SEPTIC TANK TO THE PROPOSED LANE FROM 10' TO 3' MINIMUM PER SECTION 15.405(1)(b), SHOWN AS 7' ON PLAN.
8. A REDUCTION OF THE SETBACK OF THE PROPOSED SEPTIC TANK TO THE PROPOSED LANE FROM 10' TO 3' MINIMUM PER SECTION 15.405(1)(b), SHOWN AS 7' ON PLAN.
9. TO ALLOW ONE ONE-DROP OVERFLOW HOLE DUE TO STEEP SLOPE OF EXISTING FOUNDATION, SHOWN AS 8' ON PLAN.
10. A REDUCTION OF THE SETBACK OF THE PROPOSED SEPTIC TANK TO THE PROPOSED LANE FROM 10' TO 3' MINIMUM PER SECTION 15.405(1)(b), SHOWN AS 7' ON PLAN.
11. A REDUCTION OF THE SETBACK OF THE PROPOSED SEPTIC TANK TO THE PROPOSED LANE FROM 10' TO 3' MINIMUM PER SECTION 15.405(1)(b), SHOWN AS 7' ON PLAN.
12. A REDUCTION OF THE SETBACK OF THE PROPOSED SEPTIC TANK TO THE PROPOSED LANE FROM 10' TO 3' MINIMUM PER SECTION 15.405(1)(b), SHOWN AS 7' ON PLAN.
13. A REDUCTION OF THE SETBACK OF THE PROPOSED SEPTIC TANK TO THE PROPOSED LANE FROM 10' TO 3' MINIMUM PER SECTION 15.405(1)(b), SHOWN AS 7' ON PLAN.

MICROFAST 0.5 NOTES:

- 1) BLOWER PIPING TO FACT MAY NOT EXCEED 100 FT TOTAL LENGTH AND USE A MAXIMUM OF 4 ELBOWS IN THE PIPING SYSTEM 0.5 IN. DIA. FOR DISTANCE GREATER THAN 100 FT. BLOWER PIPING MUST BE LOCATED ABOVE FLOOD LEVELS ON CONCRETE BASE 2" X 1/2" X 1/2" MINIMUM.
- 2) VOLT TO BE LOCATED ABOVE FINISH GRADE OR HIGHER TO AVOID INTERFERENCE. CAP WITH A VENT CAP WITH AT LEAST 7 1/2 IN. AN OPEN SURFACE AREA OR RUN TO DESIGNATED LOCATION. SECURE WITH STAINLESS STEEL SCREW. VOLT PIPING MUST NOT ALLOW STRESS MEASURE BUILD UP ON DUCK PRESSURE.
- 3) ALL APPOINTMENTS TO FACT (E.G. TANK PUMP OUTS, ETC.) MUST CONFORM TO ALL APPOINTMENT SCHEDULES AND REQUIREMENTS OF THE FACT AND ALL APPOINTMENTS TO FACT (E.G. TANK PUMP OUTS, ETC.) MUST CONFORM TO ALL APPOINTMENT SCHEDULES AND REQUIREMENTS OF THE FACT.
- 4) TANK VOLUME MUST BE INCREASED BY 20% IN MAXIMUM OF 10% E USED BETWEEN THE UNIT AND THE BASE OF THE TANK. CONSULT FACTORY FOR APPROVAL.
- 5) THE PRIMARY COMPARTMENT MAY BE A SEPARATE TANK.
- 6) BEFORE THE UNITS ARE SET, THEY SHALL BE SET WITH A PIPE CAP ON THE BATTLE SEPARATING THE TWO ZONES SHALL BE EXTENDED ALL THE WAY TO THE TOP OF THE TANK. CHOOSING TO USE THE PIPE CAP, THEN THE BATTLE SHALL BE AT LEAST 3" HIGHER THAN UNITS. A 1/2" DIA. AIR SUPPLY LINE SHALL BE INSTALLED TO THE TOP OF THE TANK.
- 7) ALL PUMP AND PUMP OUT PORTS MUST BE SECURED TO PREVENT ACCIDENTAL UNAUTHORIZED ACCESS.
- 8) TANK PIPING, CONDUIT, BLOWER HOUSING AND VENTS ARE PROVIDED BY OTHERS.
- 9) ALL AIR AND FLOW OF CONTAMINANT INSTALLED AFTER FACT MUST NOT IMPROVE OR RESTRICT FLOW OF CONTAMINANT.
- 10) THE AIR SUPPLY LINE AND THE AIR OUT LINE MUST BE SECURED TO PREVENT UNDESIRABLE DAMAGED. THE AIR SUPPLY LINE SHOULD BE SECURED WITH NON-CORROSIVE CLAMP OR WITHIN A VENT CAP. ALTERNATE AIR SUPPLY OPTION CONTACT MICROFAST FOR DETAILS AND COSTS.
- 11) MIN HEIGHT MAY BE REDUCED, CONSULT FACTORY AND REFER TO "SHORT-FAST-MODULE-PROCEDURE" 100".

REMOVAL & REPLACEMENT TO ELEVATION 66.0

- 1) REMOVE & REPLACE TO ELEVATION 66.0.
- 2) REMOVE & REPLACE TO ELEVATION 66.0.
- 3) REMOVE & REPLACE TO ELEVATION 66.0.
- 4) REMOVE & REPLACE TO ELEVATION 66.0.
- 5) REMOVE & REPLACE TO ELEVATION 66.0.
- 6) REMOVE & REPLACE TO ELEVATION 66.0.
- 7) REMOVE & REPLACE TO ELEVATION 66.0.
- 8) REMOVE & REPLACE TO ELEVATION 66.0.
- 9) REMOVE & REPLACE TO ELEVATION 66.0.
- 10) REMOVE & REPLACE TO ELEVATION 66.0.
- 11) REMOVE & REPLACE TO ELEVATION 66.0.
- 12) REMOVE & REPLACE TO ELEVATION 66.0.
- 13) REMOVE & REPLACE TO ELEVATION 66.0.
- 14) REMOVE & REPLACE TO ELEVATION 66.0.
- 15) REMOVE & REPLACE TO ELEVATION 66.0.
- 16) REMOVE & REPLACE TO ELEVATION 66.0.
- 17) REMOVE & REPLACE TO ELEVATION 66.0.
- 18) REMOVE & REPLACE TO ELEVATION 66.0.
- 19) REMOVE & REPLACE TO ELEVATION 66.0.
- 20) REMOVE & REPLACE TO ELEVATION 66.0.

BODING CALCULATIONS:

- 1,000 GALLON PUMP STATION
 2.40 GAL/CF * 3.14 CF = 234 GAL PER FOOT OF DEPTH
 137 GAL/FOOT * 73/4 GAL PER FOOT OF DEPTH = 5' DEPTH
 5' * 12.7 FT = 6' OF DEPTH/FOOT
- PUMP DESIGN
 ALTITUDE CHANGE = 63.85 - 53 = 12.85'
 FRICTION LOSS = 2.67' @ 0.5 GPM
 REQUIRED PUMP HEAD = 12.85 + 2.67 = 15.52'

BUDINITY CALCULATIONS 1,000 GALLON SEPTIC 11-20

- TANK BY SH&M CONCRETE MODEL 1K-10000
 WEIGHT OF EMPTY 1,000 GAL TANK (CONCRETE CORE)
 SOIL WEIGHT ABOVE TANK
 VOLUME OF TANK 44 CF (44 CF X 110 LB/CF) = 4,840 LB
 DOWNWARD FORCE = 44.00 + 4,840 = 4,884 LB
 DOWNWARD FORCE = 22.00 + 4,884 = 4,906 LB
 VOLUME OF DISPLACED WATER = 43 CF
 BUOYANT FORCE = 43.00 X 62.4 LB/CF = 2,683 LB
 BUOYANT FORCE = 26.00 X 62.4 LB/CF = 1,622 LB
 (DOWNWARD FORCE > BUOYANT FORCE)

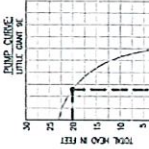

SEWAGE DISPOSAL SYSTEM UPGRADE DESIGN

PREPARED FOR: JAMES & MARY FELICI TRUSTEES
 1000 W. CENTRAL AVE.
 LAKEVILLE, MA 02447

LOCATED AT: 26 CENTRAL AVE
 LAKEVILLE, MASSACHUSETTS

DATE: 11/19/24
 SCALE: AS SHOWN

FORESIGHT ENGINEERING INC.
 1000 W. CENTRAL AVE.
 LAKEVILLE, MA 02447
 PHONE: 978-326-8888
 FAX: 978-326-8889
 WWW.FORESIGHTENG.COM

SHEET 2 OF 2



WPA Form 8A – Request for Certificate of Compliance

Massachusetts Wetlands Protection Act M.G.L. c. 131, §40

A. Project Information

Important:
When filling out forms on the computer, use only the tab key to move your cursor - do not use the return key.

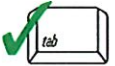

Upon completion of the work authorized in an Order of Conditions, the property owner must request a Certificate of Compliance from the issuing authority stating that the work or portion of the work has been satisfactorily completed.

1. This request is being made by:

Benjamin H. Dowling, Attorney at Law

Name

89 North Main Street

Mailing Address

Attleboro

MA

02703

City/Town

State

Zip Code

617-217-1438

Phone Number

2. This request is in reference to work regulated by a final Order of Conditions issued to:

Par-Three Realty Trust

Applicant

4/16/1998

SE192-219

Dated

DEP File Number

3. The project site is located at:

16 Margeaux Drive

Lakeville

Street Address

City/Town

035

001-001-16

Assessors Map/Plat Number

Parcel/Lot Number

4. The final Order of Conditions was recorded at the Registry of Deeds for:

Par-Three Realty Trust

Property Owner (if different)

Plymouth

16645

147

County

Book

Page

Certificate (if registered land)

5. This request is for certification that (check one):

the work regulated by the above-referenced Order of Conditions has been satisfactorily completed.

the following portions of the work regulated by the above-referenced Order of Conditions have been satisfactorily completed (use additional paper if necessary).

the above-referenced Order of Conditions has lapsed and is therefore no longer valid, and the work regulated by it was never started.



A. Project Information (cont.)

6. Did the Order of Conditions for this project, or the portion of the project subject to this request, contain an approval of any plans stamped by a registered professional engineer, architect, landscape architect, or land surveyor?

Yes

If yes, attach a written statement by such a professional certifying substantial compliance with the plans and describing what deviation, if any, exists from the plans approved in the Order.

No

B. Submittal Requirements

Requests for Certificates of Compliance should be directed to the issuing authority that issued the final Order of Conditions (OOC). If the project received an OOC from the Conservation Commission, submit this request to that Commission. If the project was issued a Superseding Order of Conditions or was the subject of an Adjudicatory Hearing Final Decision, submit this request to the appropriate DEP Regional Office (see <http://www.mass.gov/eea/agencies/massdep/about/contacts/find-the-massdep-regional-office-for-your-city-or-town.html>).



Massachusetts Department of Environmental Protection
 Bureau of Resource Protection - Wetlands
WPA Form 8A – Request for Certificate of Compliance
 Massachusetts Wetlands Protection Act M.G.L. c. 131, §40

DEP File Number:

SE192-323
 Provided by DEP

A. Project Information

Important:
 When filling out forms on the computer, use only the tab key to move your cursor - do not use the return key.



Upon completion of the work authorized in an Order of Conditions, the property owner must request a Certificate of Compliance from the issuing authority stating that the work or portion of the work has been satisfactorily completed.

1. This request is being made by:

Benjamin H. Dowling
 Name
89 North Main Street
 Mailing Address
Attleboro MA 02703
 City/Town State Zip Code
617-217-1438
 Phone Number

2. This request is in reference to work regulated by a final Order of Conditions issued to:

Applicant _____
 Dated _____ DEP File Number _____

3. The project site is located at:

16 Margeaux Drive Lakeville
 Street Address City/Town
35 001-001-16
 Assessors Map/Plat Number Parcel/Lot Number

4. The final Order of Conditions was recorded at the Registry of Deeds for:

Norja, Inc.
 Property Owner (if different)
Plymouth 20828 301
 County Book Page

Certificate (if registered land) _____

5. This request is for certification that (check one):

- the work regulated by the above-referenced Order of Conditions has been satisfactorily completed.
- the following portions of the work regulated by the above-referenced Order of Conditions have been satisfactorily completed (use additional paper if necessary).

- the above-referenced Order of Conditions has lapsed and is therefore no longer valid, and the work regulated by it was never started.



WPA Form 8A – Request for Certificate of Compliance

Massachusetts Wetlands Protection Act M.G.L. c. 131, §40

A. Project Information (cont.)

6. Did the Order of Conditions for this project, or the portion of the project subject to this request, contain an approval of any plans stamped by a registered professional engineer, architect, landscape architect, or land surveyor?

Yes

If yes, attach a written statement by such a professional certifying substantial compliance with the plans and describing what deviation, if any, exists from the plans approved in the Order.

No

B. Submittal Requirements

Requests for Certificates of Compliance should be directed to the issuing authority that issued the final Order of Conditions (OOC). If the project received an OOC from the Conservation Commission, submit this request to that Commission. If the project was issued a Superseding Order of Conditions or was the subject of an Adjudicatory Hearing Final Decision, submit this request to the appropriate DEP Regional Office (see <http://www.mass.gov/eea/agencies/massdep/about/contacts/find-the-massdep-regional-office-for-your-city-or-town.html>).



Massachusetts Department of Environmental Protection
 Bureau of Water Resources - Wetlands

WPA Form 1- Request for Determination of Applicability Lakeville
 Municipality
 Massachusetts Wetlands Protection Act M.G.L. c. 131, §40

RECEIVED

JAN 18 2024

Conservation Commission

A. General Information

Important:
 When filling out forms on the computer, use only the tab key to move your cursor - do not use the return key.



1. Applicant:
 SRPEDD
 First Name SRPEDD Last Name Conservation Commission
 Address 88 Broadway
 City/Town Taunton State MA Zip Code 02780
 Phone Number 508-824-1367 Email Address dbelknap@srpedd.org

2. Property Owner (if different from Applicant):
 MassDOT/ District 5
 First Name 1000 County Street Last Name
 Address Taunton State MA Zip Code 02780
 City/Town 857-368-5000 State Zip Code
 Phone Number Email Address (if known)

3. Representative (if any)
 Brian Mahoney
 First Name Brian Last Name Mahoney
 Pare Corporation
 Company Name 8 Blackstone Valley Pl
 Address Lincoln RI 02865
 City/Town 401-414-5128 State Zip Code
 Phone Number Email Address (if known) bmahoney@parecorp.com

B. Project Description

1. a. Project Location (use maps and plans to identify the location of the area subject to this request):

State Route 18/ Snake River Culvert (362 Bedford St) Lakeville
 Street Address 41.83321 City/Town -70.94139
 Latitude (Decimal Degrees Format with 5 digits after decimal e.g. XX.XXXXX) Longitude (Decimal Degrees Format with 5 digits after decimal e.g. -XX.XXXXX)

[How to find Latitude and Longitude](#)

[and how to convert to decimal degrees](#)

Assessors' Map Number Assessors' Lot/Parcel Number

b. Area Description (use additional paper, if necessary):

Adjacent to Bridge No. L-01-017 on State Route 18 (Bedford St), between Long Pond and Assawompsett Pond

c. Plan and/or Map Reference(s): (use additional paper if necessary)

Revised Boring Location Plan (2 sheets) 1/3/2024
 Title Date
 Title Date



B. Project Description (cont.)

2. a. Activity/Work Description (use additional paper and/or provide plan(s) of Activity, if necessary):

Perform one (1) exploratory boring to furnish subsurface data and soil samples required to complete the preliminary engineering evaluation for the Snake River Culvert Replacement Assessment & Evaluation Project. The proposed boring location is approximately 22 feet north of Bridge No. L-01-017 within the southbound shoulder at the west side of State Route 18 (Bedford St). One (1) soil boring with a truck drill rig to a depth of 40 feet below the roadway surface is proposed.

- b. Identify provisions of the Wetlands Protection Act or regulations which may exempt the applicant from having to file a Notice of Intent for all or part of the described work (use additional paper, if necessary).

310 CMR 10.02(2)(b)(2)(g)

3. a. If this application is a Request for Determination of Scope of Alternatives for work in the Riverfront Area, indicate the one classification below that best describes the project.

- Single family house on a lot recorded on or before 8/1/96
- Single family house on a lot recorded after 8/1/96
- Expansion of an existing structure on a lot recorded after 8/1/96
- Project, other than a single-family house or public project, where the applicant owned the lot before 8/7/96
- New agriculture or aquaculture project
- Public project where funds were appropriated prior to 8/7/96
- Project on a lot shown on an approved, definitive subdivision plan where there is a recorded deed restriction limiting total alteration of the Riverfront Area for the entire subdivision
- Residential subdivision; institutional, industrial, or commercial project
- Municipal project
- District, county, state, or federal government project
- Project required to evaluate off-site alternatives in more than one municipality in an Environmental Impact Report under MEPA or in an alternatives analysis pursuant to an application for a 404 permit from the U.S. Army Corps of Engineers or 401 Water Quality Certification from the Department of Environmental Protection.

- b. Provide evidence (e.g., record of date subdivision lot was recorded) supporting the classification above (use additional paper and/or attach appropriate documents, if necessary.)
-



C. Determinations

1. I request the Lakeville Conservation Commission make the following determination(s). Check any that apply:

- a. whether the **area** depicted on plan(s) and/or map(s) referenced above is an area subject to jurisdiction of the Wetlands Protection Act.
- b. whether the **boundaries** of resource area(s) depicted on plan(s) and/or map(s) referenced above are accurately delineated.
- c. whether the **Activities** depicted on plan(s) referenced above is subject to the Wetlands Protection Act and its regulations.
- d. whether the area and/or Activities depicted on plan(s) referenced above is subject to the jurisdiction of any **municipal wetlands' ordinance or bylaw** of:

Town of Lakeville

Name of Municipality

- e. whether the following **scope of alternatives** is adequate for Activities in the Riverfront Area as depicted on referenced plan(s).

D. Signatures and Submittal Requirements

I hereby certify under the penalties of perjury that the foregoing Request for Determination of Applicability and accompanying plans, documents, and supporting data are true and complete to the best of my knowledge.

I further certify that the property owner, if different from the applicant, and the appropriate DEP Regional Office were sent a complete copy of this Request (including all appropriate documentation) simultaneously with the submittal of this Request to the Conservation Commission.

Failure by the applicant to send copies in a timely manner may result in dismissal of the Request for Determination of Applicability.

Signatures:

I also understand that notification of this Request will be placed in a local newspaper at my expense in accordance with Section 10.05(3)(b)(1) of the Wetlands Protection Act regulations.

Signature of Applicant

Brian J. Mahoney

Digitally signed by Brian J. Mahoney
DN: c=US, E=bmahoney@statecorp.com,
O=State Corporation, CN=Brian J. Mahoney
Date: 2024.01.17 16:42:57-0507

Date

1/17/2024

Signature of Representative (if any)

Date

CITY/TOWN LAKEVILLE	B.I.N. 9P4	BR. DEPT. NO. L-01-017	8.-STRUCTURE NO. L01017-9P4-DOT-CUL	INSPECTION DATE SEP 23, 2016
------------------------	---------------	---------------------------	--	---------------------------------

SKETCHES

RECEIVED

JAN 18 2024

Conservation Commission

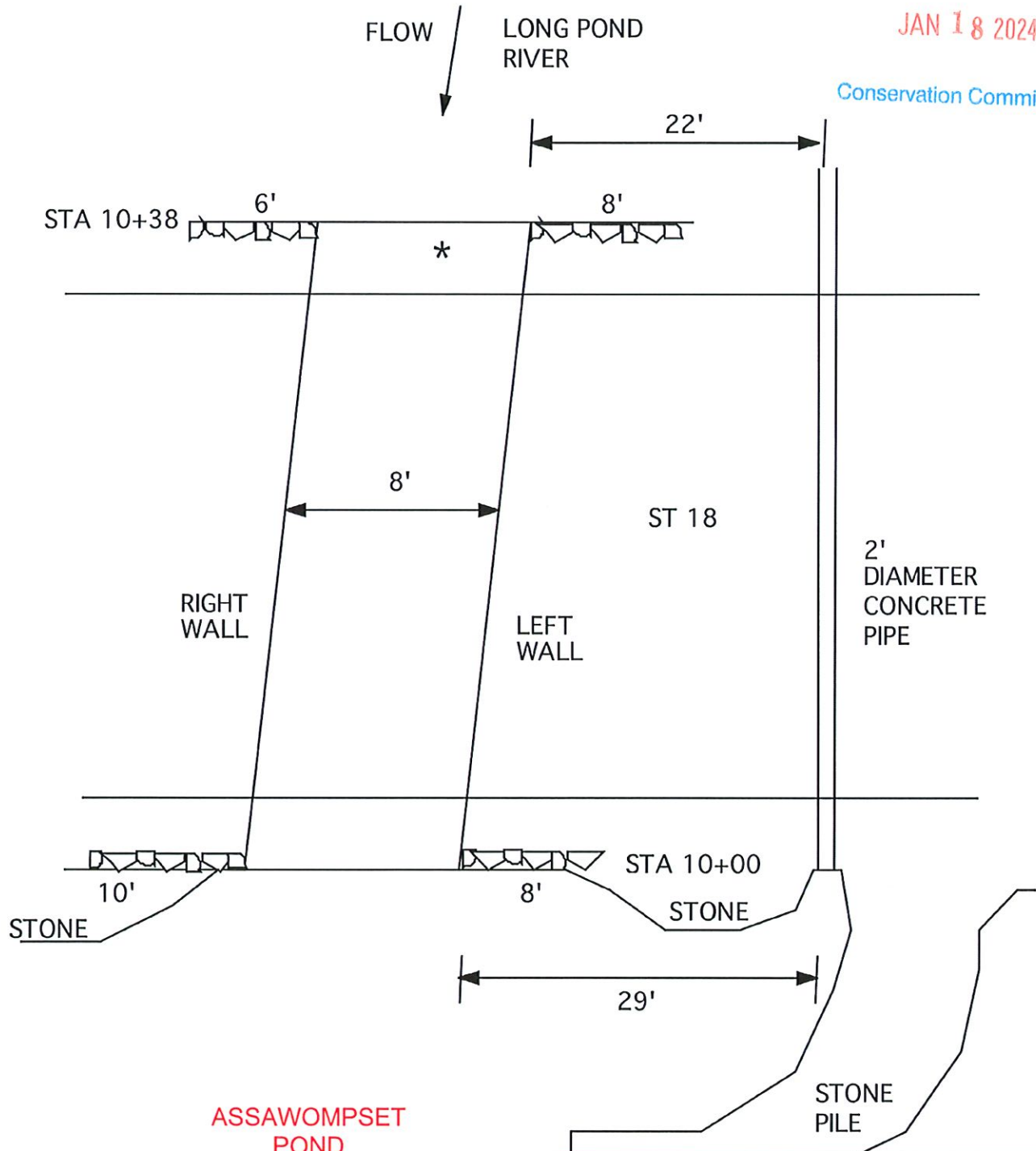

* = WATER CONTROL SHOT

Sketch 1: PLAN VIEW - NOT TO SCALE

MassDOT SHAPS
 Permit Number: 5-2023-0860
 Applicant: SRPEDD
 Location: LAKEVILLE, 18, 362 Bedford St
 Type: Borings/Test Pits: Paved Areas
 Design Consultant: Pare Corporation
 Date: 1/3/2024

REVISED BORING LOCATION PLAN
SHEET 2 OF 2

9073

CONTINUED ON SHEET 13

DATE	REVISED	BY	CHKD	APP'D
1	19	12	16	
MASS. N.F.A.				

LAKEVILLE
 BEDFORD ST - RTE. 18 & 105

PROPOSED HIGHWAY GUARD TYPE SS
 4' RADIUS STA. 149+25 TO STA. 176+30 LEADING END LT.
 BURIED END STA. 172+00 TO STA. 179+50 BURIED END RT.
 TRAILING END STA. 177+65 TO STA. 184+75 BURIED END LT.

DRAINAGE DETAILS
 SEE SHEET 21

NOTE: UTILITY POLES TO BE RER BY OTHERS

ASSAWOMPSET POND

CITY OF TAUNTON

LAKE ASSAWOMPSET

DEAN I. AND MICHELLE L. CONEY

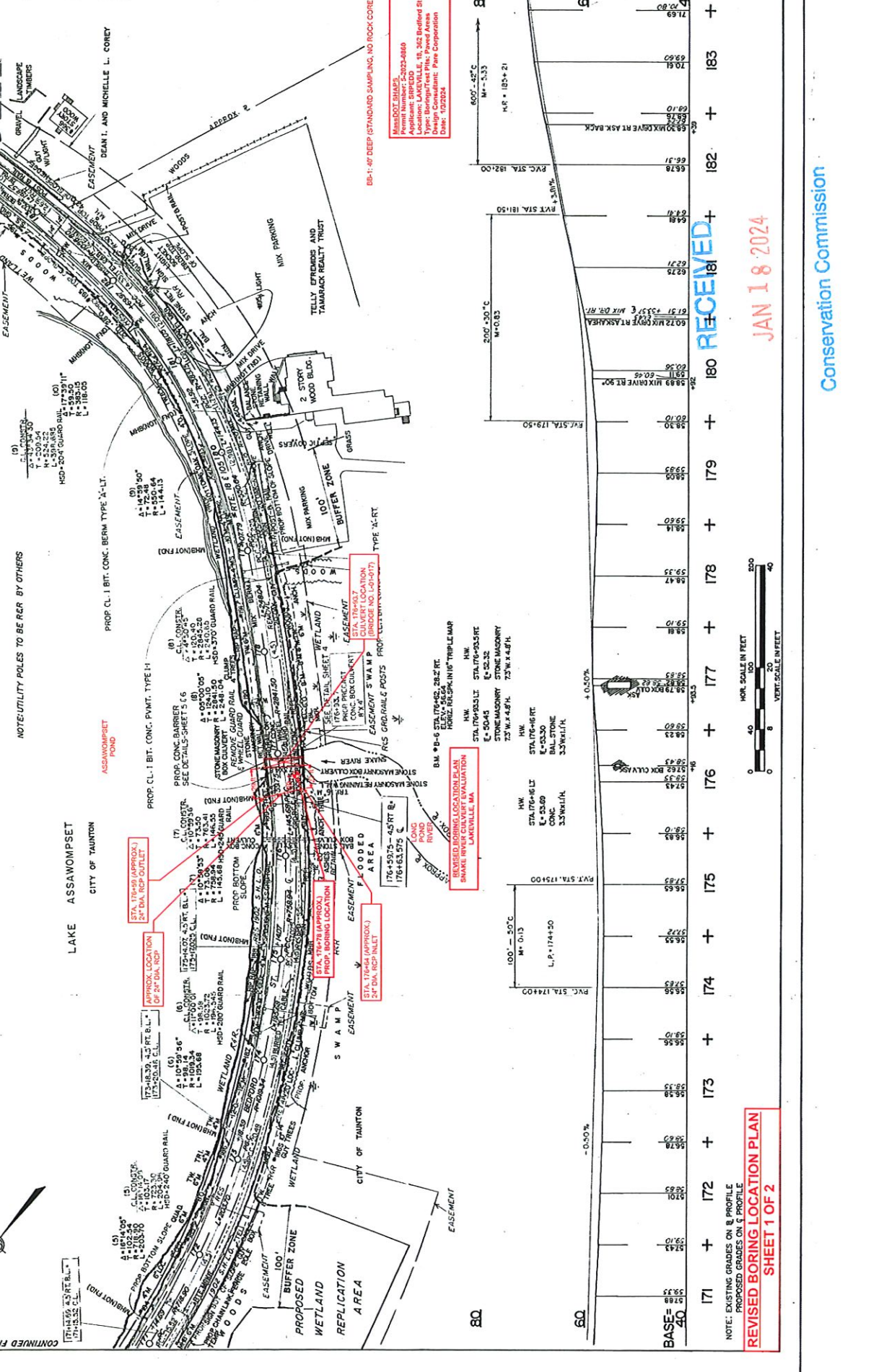

MISSOCT IMAGES
 Permit Number: 5020-0869
 Location: LAKEVILLE, 15, 305 Bedford St
 Type: Bridge/Foot Pile; Paved Areas
 Date: 10/20/24

BB-1: 40' DEEP (STANDARD SAMPLING, NO ROCK CORE)

REMOVED BORING LOCATION PLAN
 SMALL RIVER CULVERT EVALUATION
 LAKEVILLE, MA

BEMED BORING LOCATION PLAN
 SMALL RIVER CULVERT EVALUATION
 LAKEVILLE, MA

BEMED BORING LOCATION PLAN
 SMALL RIVER CULVERT EVALUATION
 LAKEVILLE, MA

BEMED BORING LOCATION PLAN
 SMALL RIVER CULVERT EVALUATION
 LAKEVILLE, MA

BEMED BORING LOCATION PLAN
 SMALL RIVER CULVERT EVALUATION
 LAKEVILLE, MA

BEMED BORING LOCATION PLAN
 SMALL RIVER CULVERT EVALUATION
 LAKEVILLE, MA

BEMED BORING LOCATION PLAN
 SMALL RIVER CULVERT EVALUATION
 LAKEVILLE, MA

RECEIVED
 JAN 18 2024

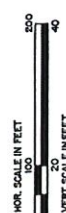

NOTE: EXISTING GRADES ON & PROFILE
 PROPOSED GRADES ON & PROFILE
 REVISED BORING LOCATION PLAN
 SHEET 1 OF 2

Conservation Commission

Lori Canedy

From: Bob <rjbouchard@verizon.net>
Sent: Friday, January 12, 2024 11:34 AM
To: Lori Canedy
Subject: Fw: Wonder Walks &

FYI

----- Forwarded Message -----

From: Tabitha Yeager <tabitha@coddwomplecrew.com>
To: "rjbouchard@verizon.net" <rjbouchard@verizon.net>
Sent: Friday, January 12, 2024 at 10:24:48 AM EST
Subject: Wonder Walks &

Good morning Robert,

Thank you again for allowing me the opportunity to present to the Conservation Commission on Tuesday January 23rd. Below please find my bio and a brief description on what I would like to do.

I am Tabitha Yeager. Over the last 20+ years I have been working in the field of environmental education. With experience working for MassAudubon as a teacher naturalist, as formal high school educator, and as an educational consultant. For more info about me feel free to read my bio on my website:



BIO
coddiwomplecrew.com

In addition, I have lived in Lakeville for the past 13 years and am really excited to build some local environmental education based programming. Also, here is a little more info about my guiding principles:



OUR STORY
coddwomplecrew.com

I am hoping to offer a Sensing the Seasons Wonder Walk session on some of the Conservation Commission lands. Over the course of the winter or spring, depending on approval and logistics, I would conduct 3-6 walks with a group of approximately 5-10 families. These walks will be with mixed ages and would be designed to teach these families how to use my Sensing the Seasons Inspiration Packs. This will be a paid for program sold as a package which will include an inspiration pack, the walks, and additional support/guidance for families to really learn how to use their senses more deeply in nature. Here are a few links to learn more about the packs:

Flora Ice Gems



PRODUCT INFO
coddiwomplecrew.com

<https://www.coddiwomplecrew.com/sensing-the-seasons>

My hope is that this could be a collaboration that would grow into more programming and become mutually beneficial overtime.

If you have additional questions or need additional information from me before the meeting on 1/24 please let me know.

Thank you for your time and consideration!

Have a great day and weekend!
Tabitha Yeager
781-856-1856